

ICONIQ

INSTALLATION GUIDE



CONTENTS

1. Preparing for Installation	2
2. Eaves Installation	4
3. Hip & Spider Rafter Installation	5
4. Ridge / Spider Installation	6
5. Rafter / Jack Rafter Installation	7
6. Eaves / Spider Seal Installation	8
7. Glazing Installation	10
8. Top Capping Installation	11
9. Glazing Bar End Cap Installation	13
10. System Components	14
11. Assembly Cross Section	22
12. Care and Maintenance	24



BE SAFE WHEN WORKING AT HEIGHT

Ensure you conform to the latest Work at Height Regulations. For more details, visit:
www.hse.gov.uk/work-at-height

If in doubt at any stage

Please contact the customer services department.



01773 842336



conservatories@deeplas.co.uk

PRE-INSTALLATION

SURVEYING WARNING



Good surveying is essential to ensure a trouble free successful installation and to avoid costly remakes caused by incorrect measuring.

When surveying it is the surveyor's responsibility to determine that the structural openings and surrounding areas are in a state of good repair and provide the correct dimensions for manufacture.

1. PREPARING FOR INSTALLATION

1.0

Before unpacking the Iconiq pitched lantern roof, you should review the supplied layout drawing (shown right). This will be located in the ancillary box.

The dimensions shown on this plan are for the external face of the supporting upstand. Ensure these dimensions are consistent with the host building.

The Iconiq ring beam allows a 10mm tolerance per face if the overall width and length of the kerb perimeter are oversized.

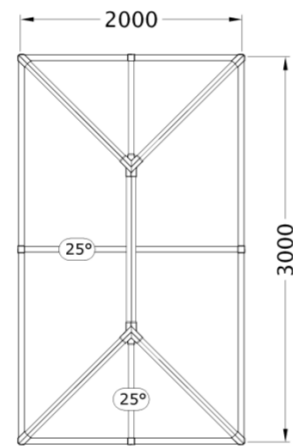

Fig. 1

1.1

The Kerb is required to be a minimum thickness of 115mm and a recommended thickness of 118mm including plasterboard. Thicker kerbs can be used but additional trimming to the kerb internally may be necessary for aesthetic reasons.

Kerb height should be a minimum of 150mm above the finished roof level in line with BS6299:2018 and in the case of protected roof systems this is where the top of paving, gravel, planted vegetation etc. is the finished roof level. (See Fig. 2)

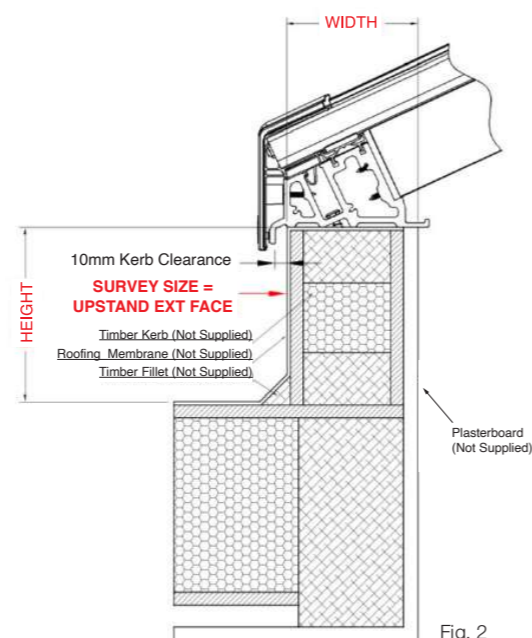

Fig. 2

1.2

The kerb corners should also be square. Check the difference between the diagonals to see if the ring beam overhang will need adjusting around the perimeter, as well as checking the diagonals to ensure the kerb is square (see Fig. 3).

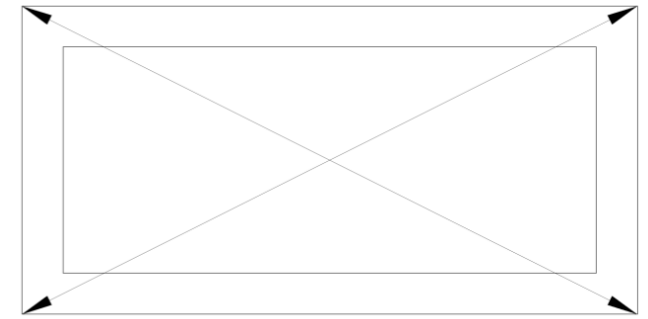

Fig. 3

1.3 TOOL LIST



Tape Measure



Impact Driver

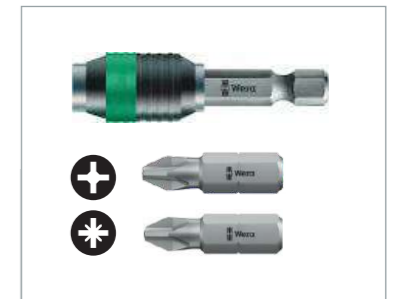

Bit Holder
PH2 Bit | PZ2 Bit



Sealant Gun & LMN Sealant



Nylon Mallet

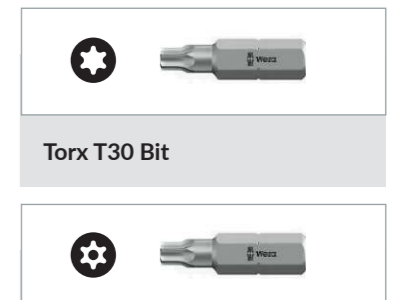

Torx T30 Bit



Security Bit
(Included with Iconiq Roof Kit)



24mm Spanner or
Socket & Wrench



6mm Allen Key



Short piece of Timber

2. EAVES INSTALLATION

2.0

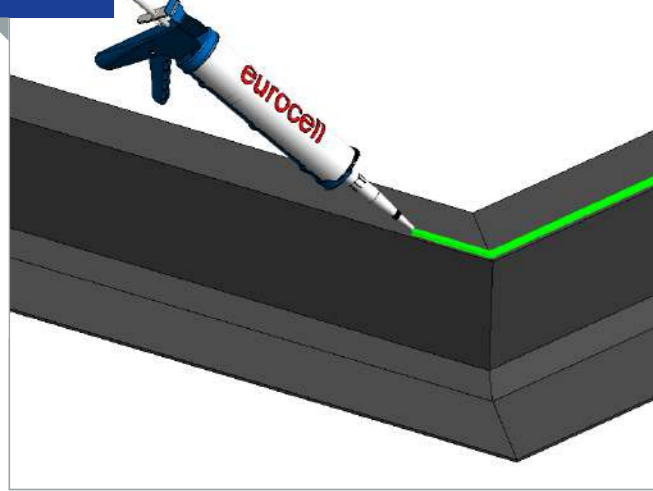

Run a generous bead of low modulus neutral cure sealant around the perimeter of the kerb as shown above.

2.1



Locate the eaves assemblies onto kerb and adjust the overhang on all sides aiming for 10mm clearance but ensure eaves corners are square.

2.2

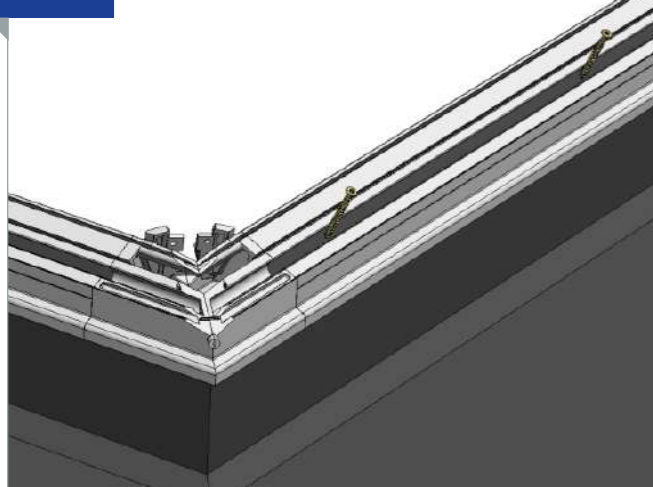

Fix one of the longest eaves to the kerb using 7.5x80mm Frame Screws through the each of the predrilled holes, T30 driver bit included in ancillary box.

2.3

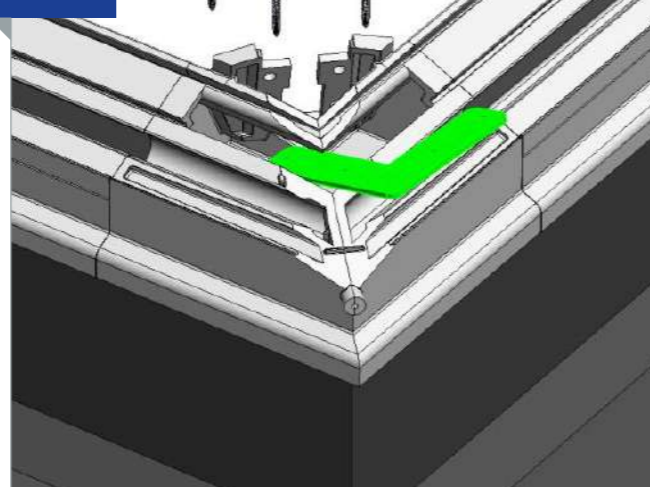

Insert steel eaves corner cleats into the corner assemblies, then using the fixed eaves as the datum check the diagonals across opposing corners and adjust until within 5mm difference of each other. **Ensure corner mouldings are tight to each other.** Then fix eaves corner cleats with 4.8x50 Pan Head Screws and eaves with 7.5x80mm Frame Screws.

3. HIP & SPIDER RAFTER INSTALLATION

3.0

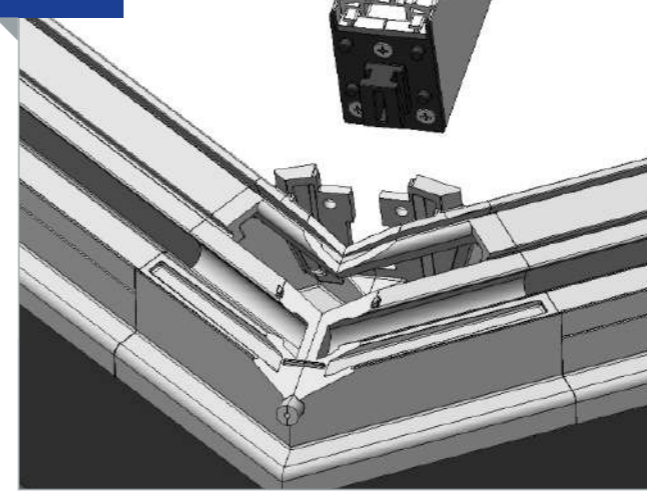

Ensure the base of the hip is correctly identified by checking the jack rafter bracket orientations if present, then slide the thermal core up as shown.

3.1

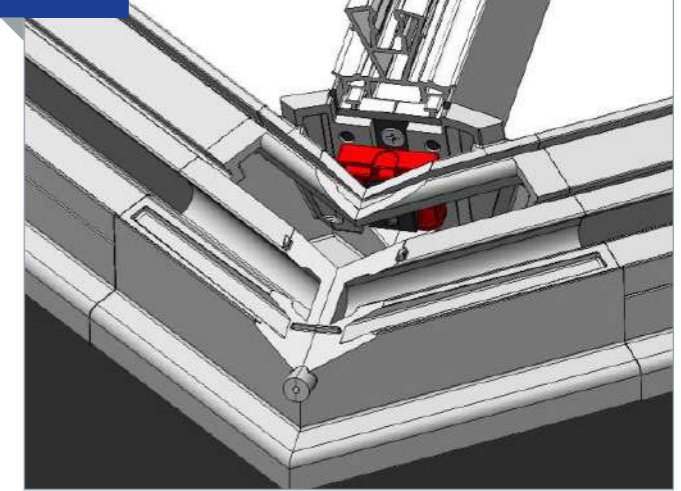

Insert the hip into the eaves corner from inside or above and then install the red Q-lok Plate until fully located down.

3.2

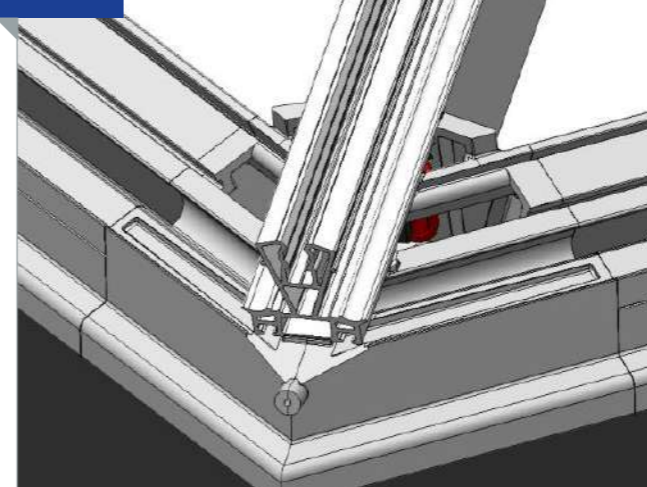

Once fully clipped allow the thermal core to slide down to the eaves corner ribs.

3.3

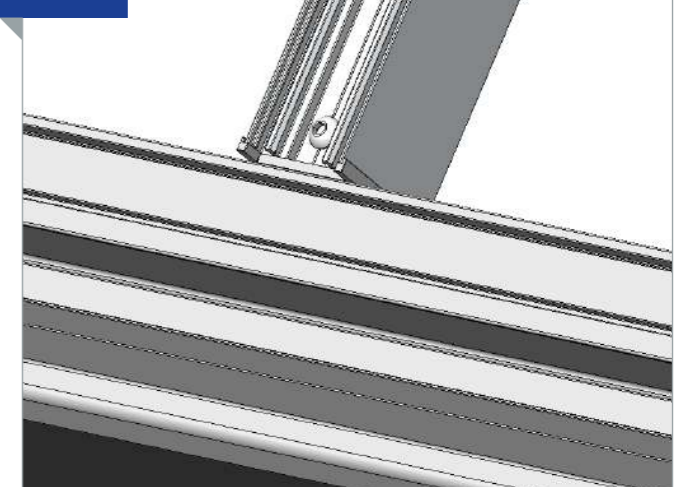

If the Iconiq roof design includes central spider rafters ensure these are loosely fitted to the eaves brackets using M8 button head bolts.

4. RIDGE / 4-WAY SPIDER INSTALLATION

4.0

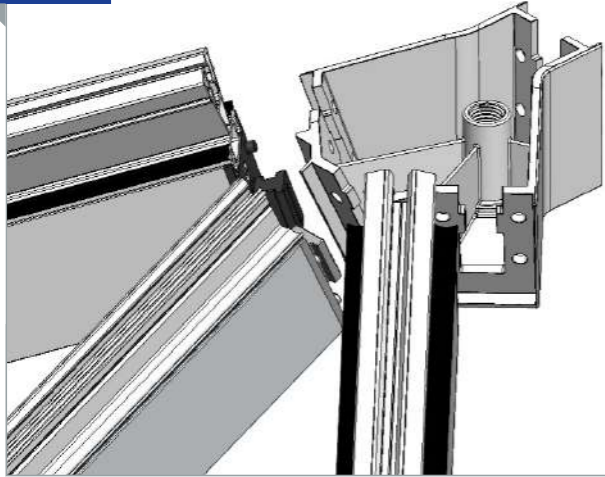

Ridge - Offer the 2 or 3 way spider moulding up to the hip and rafter ends. The rafter and hip brackets can enter the spider from the front or slide in from above.

4.1

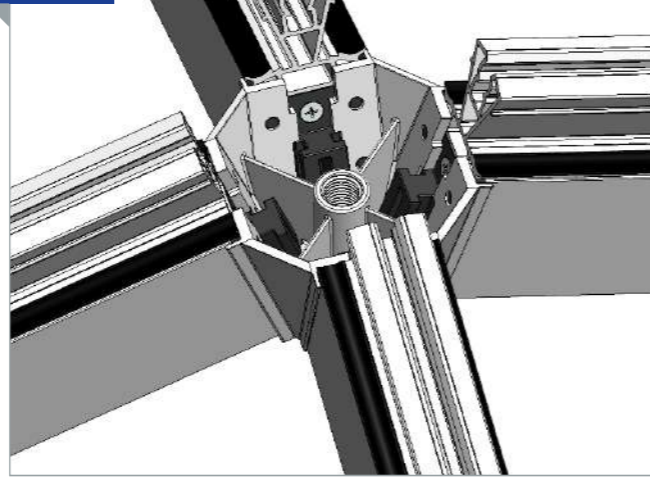

4-Way Spider - Offer the 4 way spider up to the hip ends. The hip brackets can enter the spider from the front or slide in from above. Once all hips are located, install the red Q-Lok clips as shown in 4.3.

4.2

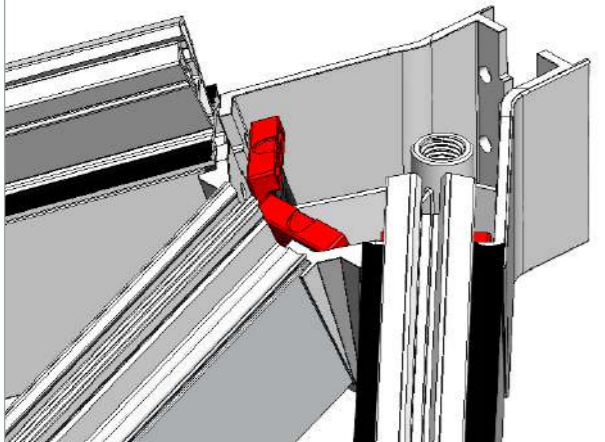

Once the spider is positioned correctly, loosely install the red Q-Lok clips to hold in position.

4.3

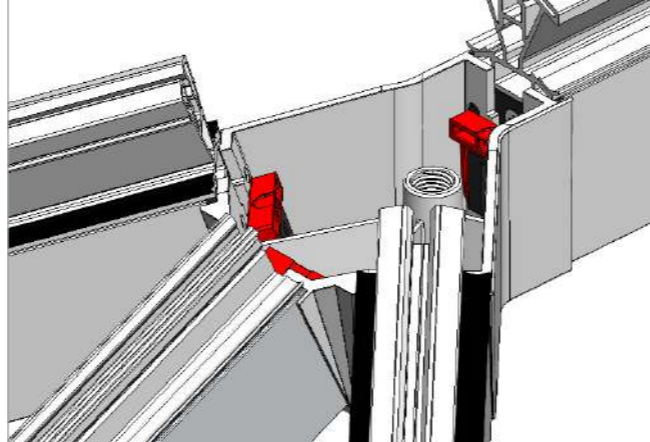

Once both spiders are loosely fitted, install the ridge beam into both spiders by offering it down vertically. When fully located, install the red Q-Lok clips to secure the ridge, then ensure all the Q-Loks are fully clipped down. Use a mallet if necessary.

5. RAFTER INSTALLATION

5.0

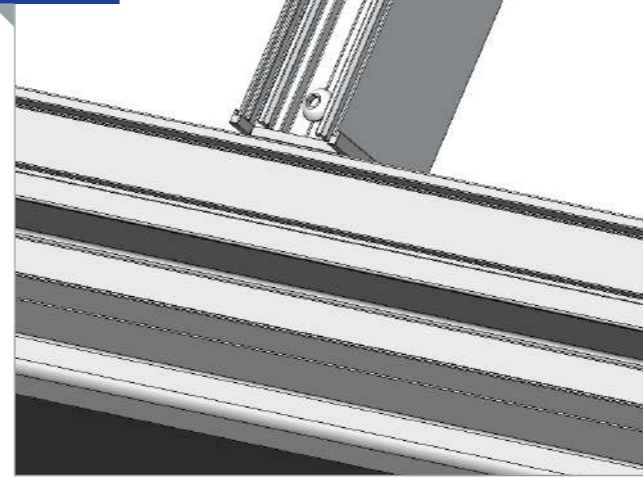

Locate the end of the rafter on the eaves rafter bracket and loosely install a M8 x 20 Button Head screw. Then proceed to either 5.1 or 5.2 depending on rafter type.

5.1

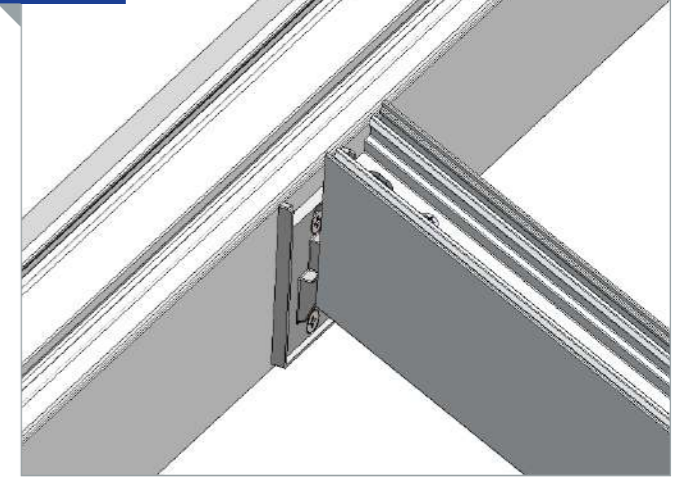

Ridge Rafter - Allow the rafter to rotate down towards the ridge so the bracket wedges engage with each other. The rafter may require a tap with a mallet to fully locate down, install a M8 x 20 Button Head Screw. Do not over torque.

5.2

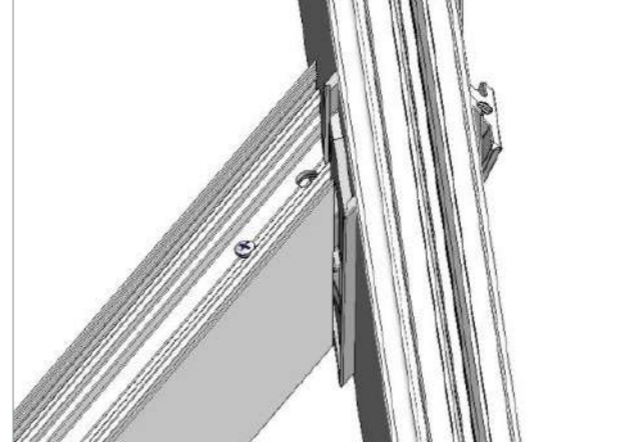

Jack Rafter - Allow the jack rafter to rotate down towards the hip so the jack rafter bracket wedges engage with each other. The jack rafter may require a tap with a mallet to fully locate down, install a M8 x 20 Button Head Screw. Do not over torque.

5.3

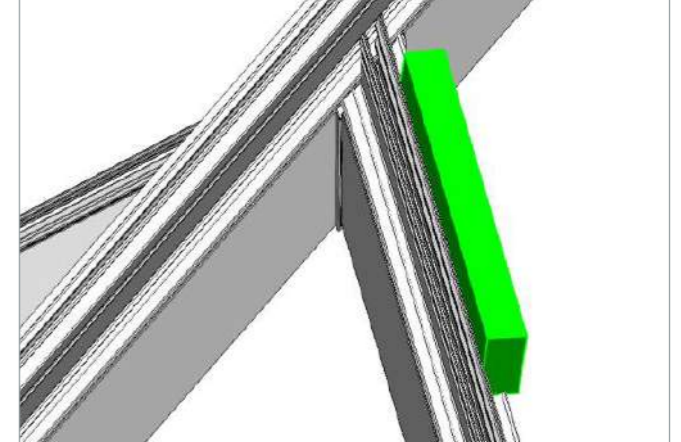

Once all the rafters are installed **ensure all fixings are tightened**. Position a small piece of timber on the side of the rafter thermal cores and hit with a mallet, repeat on the opposing side and then continue down bar. Ensure the thermal core has its fixing barbs fully located along its entire length.

6. EAVES SEAL INSTALLATION

6.0

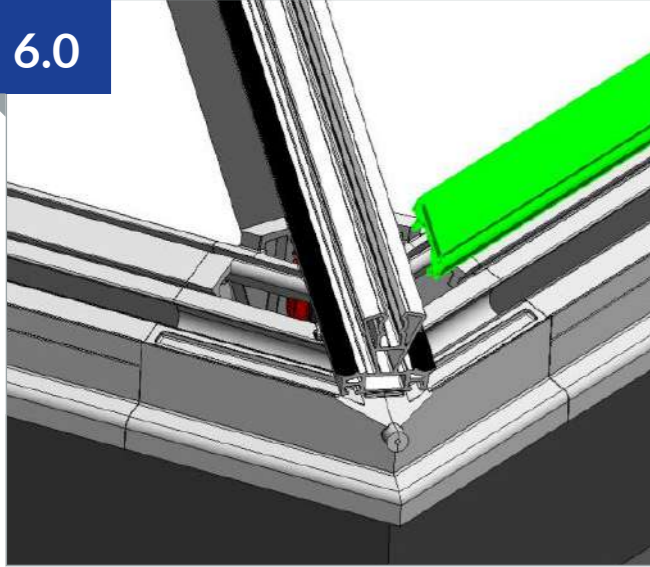

Depending on design some eaves seals may be pre-installed. Install any remaining eaves seals by clipping into the eaves beam as shown using a nylon mallet.

6.1

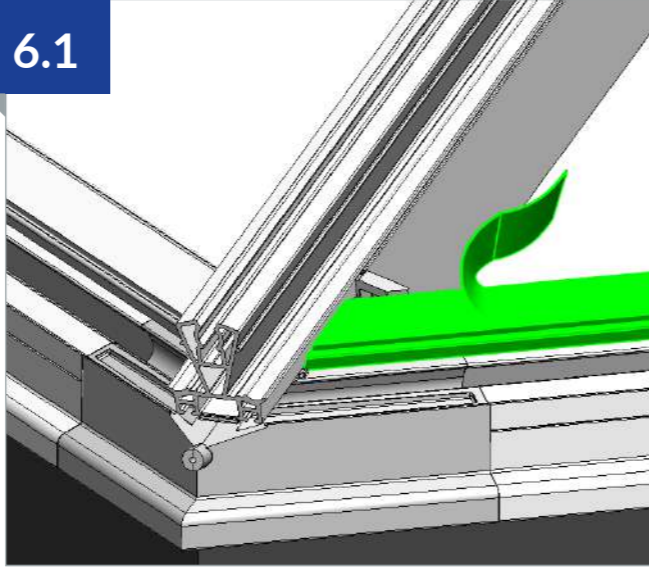

On each eaves seal peel back a small section of eaves seal tape film and fold to the inside to allow it to be peeled away once glazed. Alternately, fully remove film and spray with a mist of water to allow the glazing to move whilst positioning.

SPIDER SEAL INSTALLATION

6.2

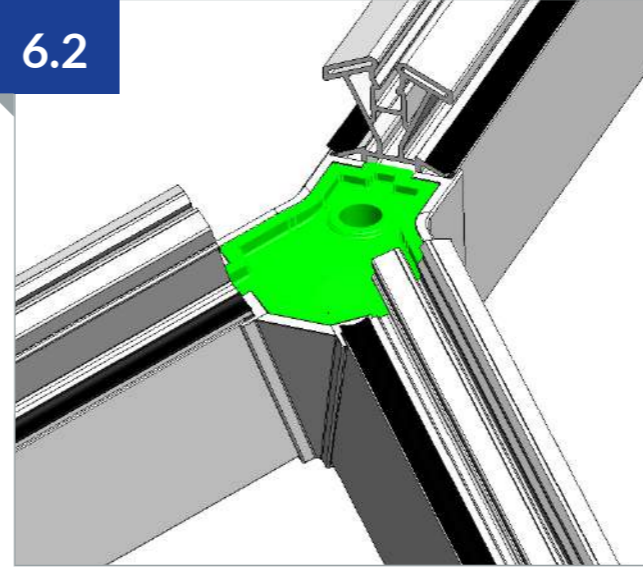

Install the spider seal plate into the spider. The top faces should be flush, if not check the red Q-Loks are fully down. The drainage legs will overlap into the glazing bar thermal cores.

6.3

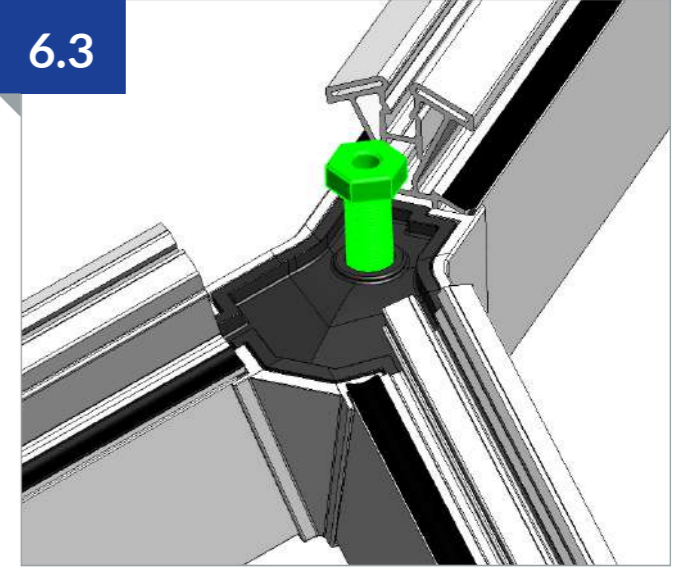

Screw the hollow M10 nylon bolt into the spider using a 24mm spanner/socket.

6.4

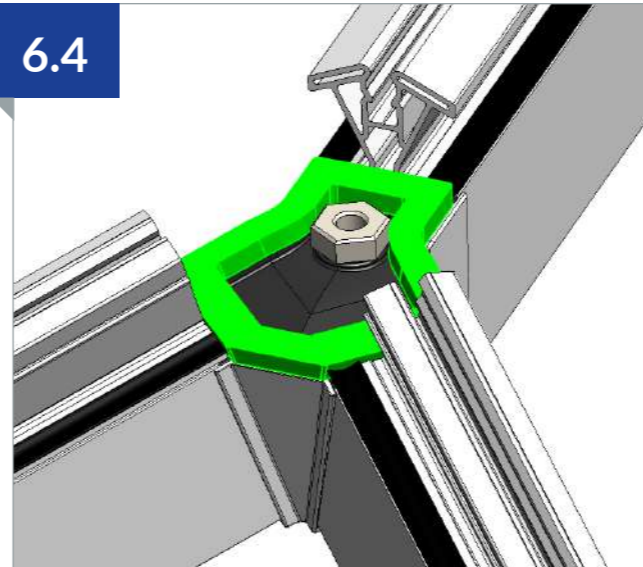

Remove the film from the lower spider seal and carefully stick to the spider perimeter.

7. GLAZING INSTALLATION

7.0

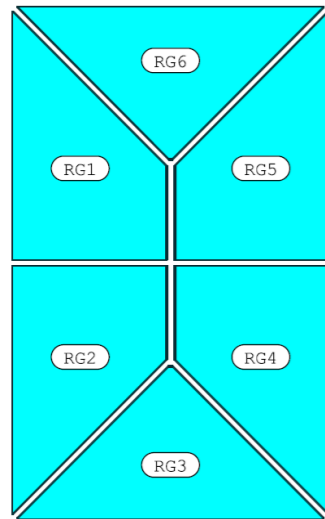

Ensure you have selected the correct glazing pane using the supplied location diagram and ensure any self clean coatings are facing externally by checking the glass labels.

7.1

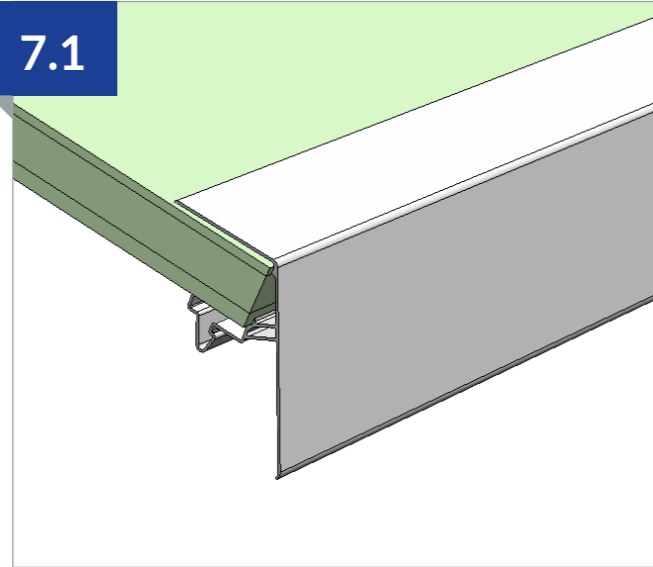

Install the aluminium glazing fascia trim to the bottom edge of the glass ensuring its centrally positioned with equal set back on both sides.

7.2

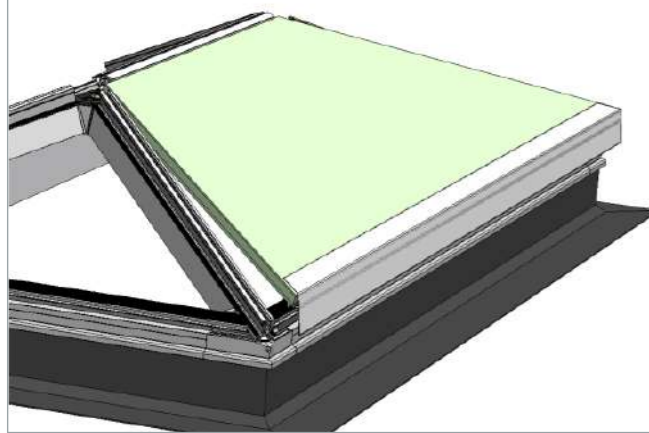

Slide the glass into the ridge thermal core at an elevated angle as shown, ensuring not to fold the ridge gasket back on itself, then lower so the fascia hooks into the eaves beam channel. Ensure the glazing is positioned square with equal clearances down the sides. The eaves beam seal tape can now be removed from inside the building.

8. TOP CAP INSTALLATION

8.0

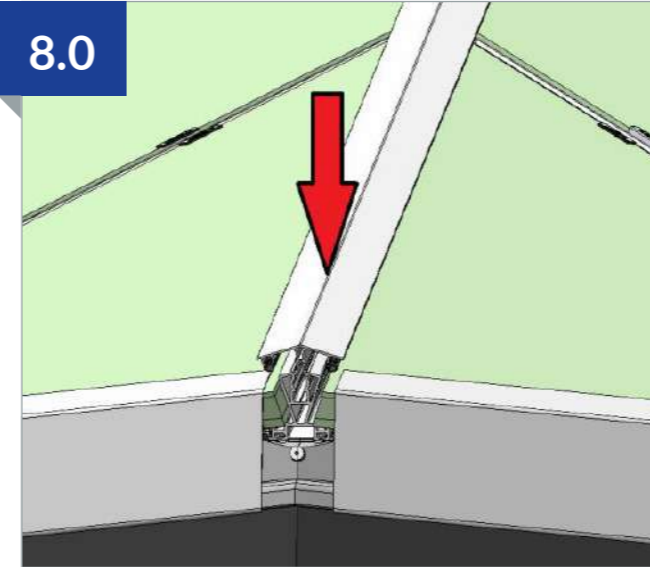

Using a short piece of timber and a nylon mallet, tap the aluminium hip and spider rafter top caps down into thermal cores until fully engaged into the barbs along the entire length.

8.1

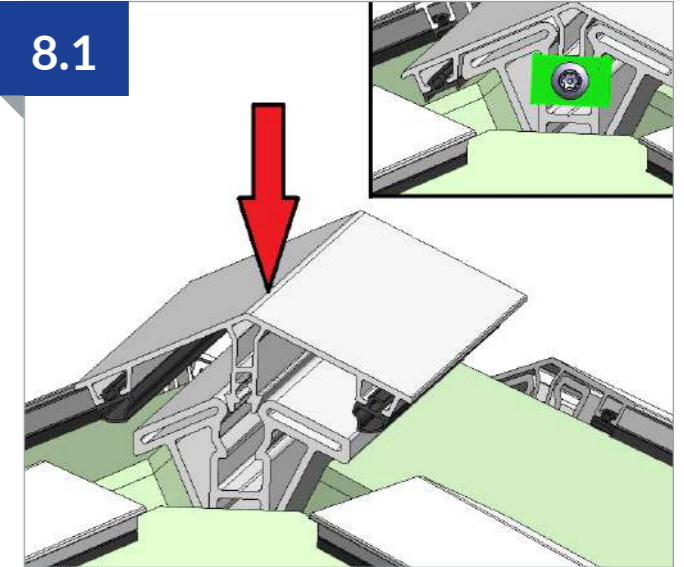

Using a short piece of timber and a nylon mallet, tap the ridge top cap down into the ridge thermal core until fully engaged into the barbs along the entire length. Then install the security clip and screw to each end of the ridge.

8.2

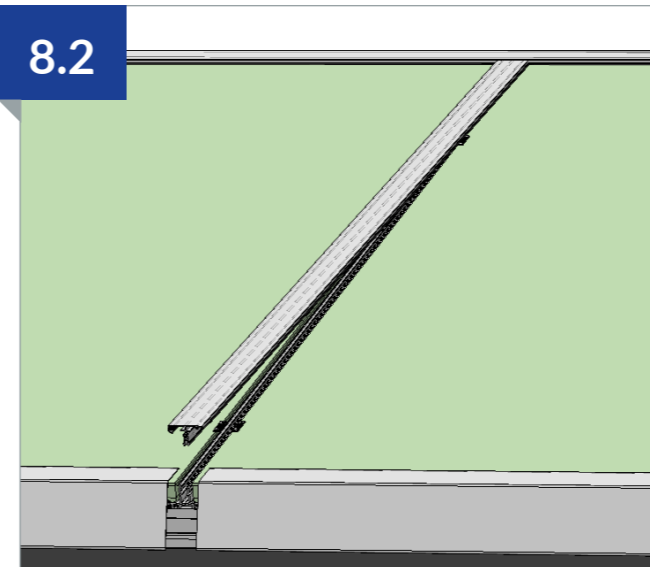

If the design has intermediate ridge rafters, angle the rafter top cap up to allow it to tuck under the ridge top cap drip, then using a short piece of timber and a nylon mallet tap the aluminium rafter top caps down into the rafter thermal core until fully engaged into the barbs along the entire length. Tap the capping up to ensure tight interface with ridge.

8.3

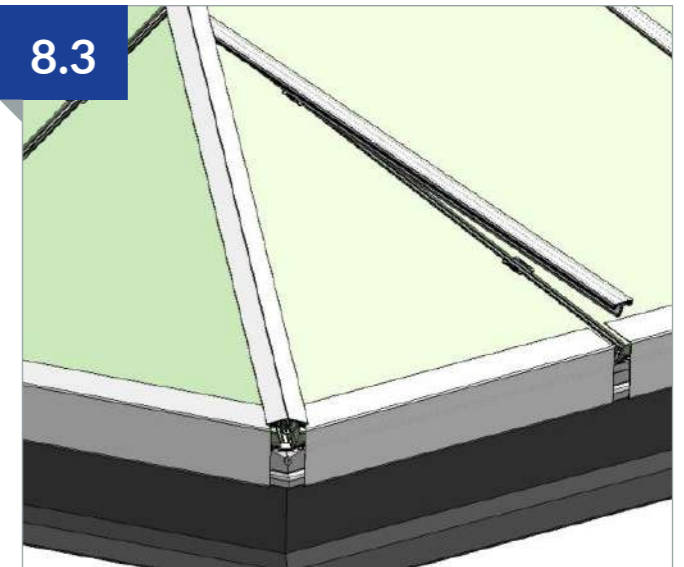

If the design has jack rafters, angle the rafter top cap up to allow it to tuck under the hip top cap drip then using a short piece of timber and a nylon mallet tap the aluminium rafter top caps down into the rafter thermal core until fully engaged into the barbs along the entire length. Tap the capping up to ensure tight interface with hip.

8. TOP CAP INSTALLATION

8.4

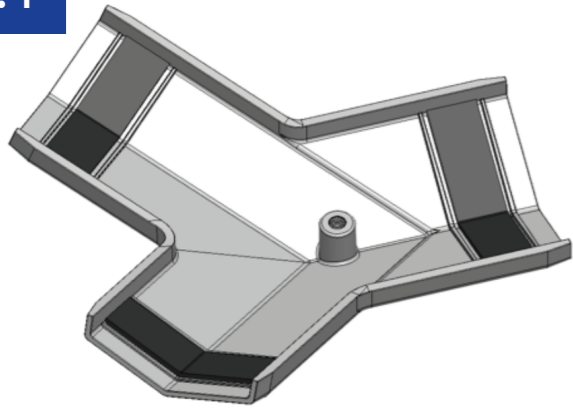

Remove the tape from the self-adhesive foam strips and stick to the underneath of the aluminium spider cap at each ridge and glazing bar location.
Ridge= 95mm Long
Hip = 74mm Long
Rafter = 51mm Long

8.5

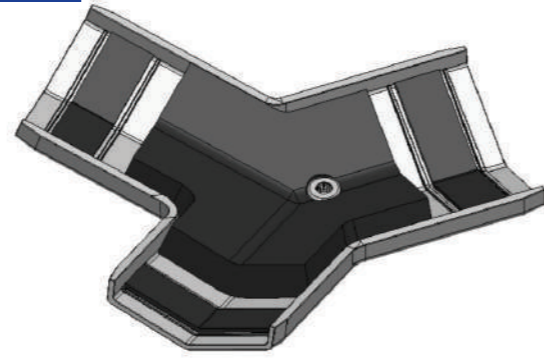

Remove the film from the upper spider seal and install into the spider top cap as shown and then position over the ridge ready for fixing.

8.6

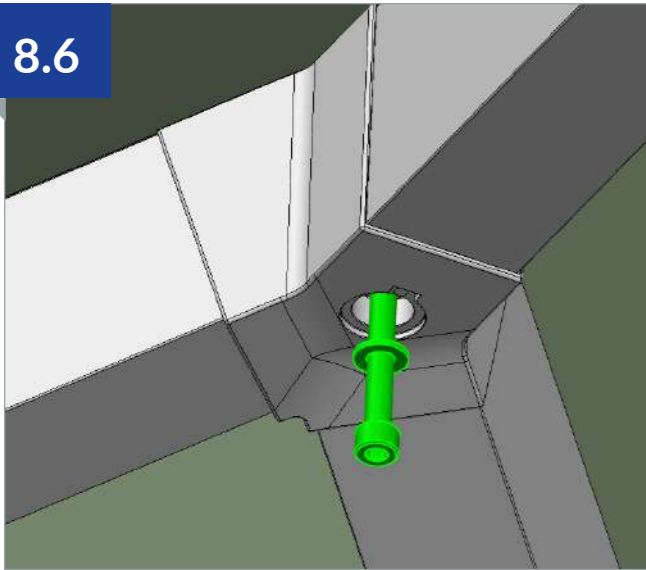

Slide the M8 Bolt/Washer through the spider from the inside and screw into the external spider cap. Tighten using 6mm Allen Key until the top cap is pulled tightly down against ridge and glazing bars.

8.7

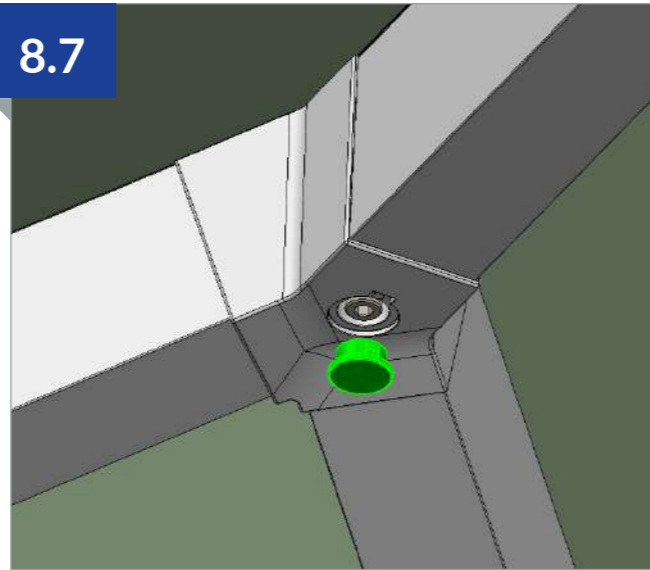

Install the plastic spider plug (ICQ4291) into the base of the spider.

9. GLAZING BAR END CAP INSTALLATION

9.0



Install the Thermal Core Clip and Security Screw as shown to the hip or rafter end as shown. (Security driver bit included in ancillary box.)

9.1

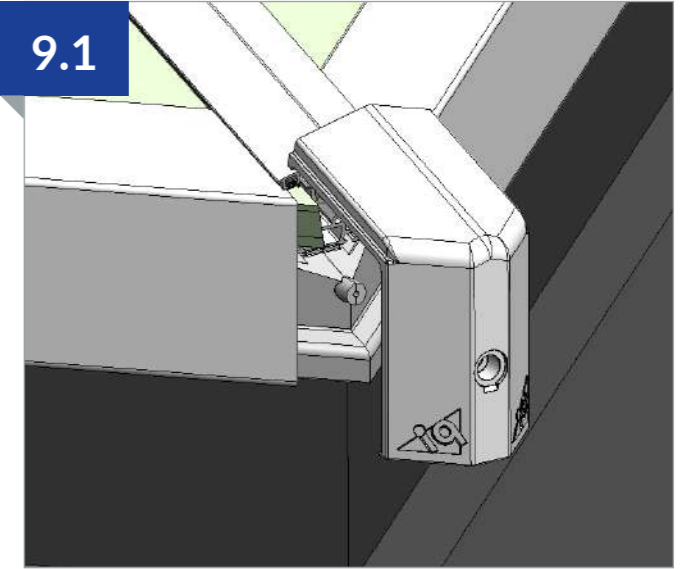

Position the Hip End Cap onto the hip end and eaves corner spigot.

9.2

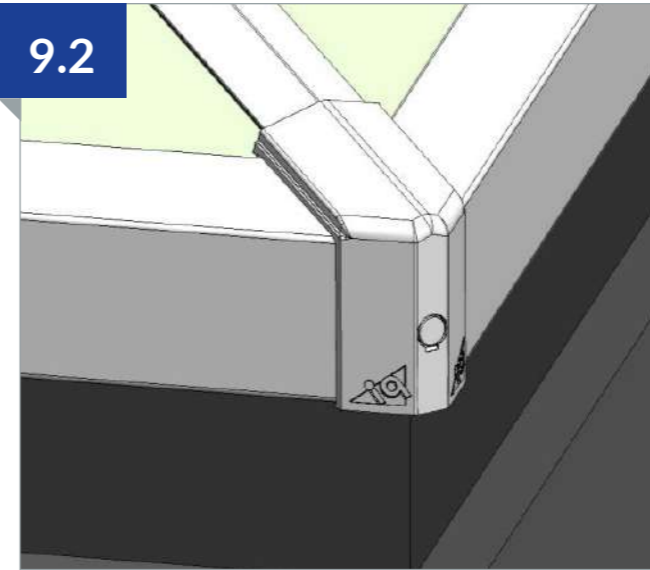

Whilst holding the end cap firmly up to the eaves corner, fix using a security screw and then install the plastic end cap plug.

9.3

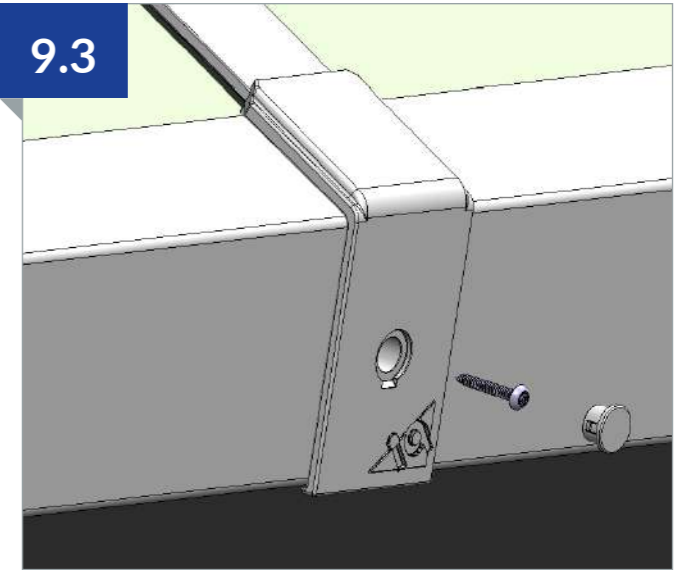

If rafters are present in the design, firmly hold the rafter end cap up to the eaves, fix using a security screw into the pre piloted eaves and then install the plastic end cap plug.

10. SYSTEM COMPONENTS

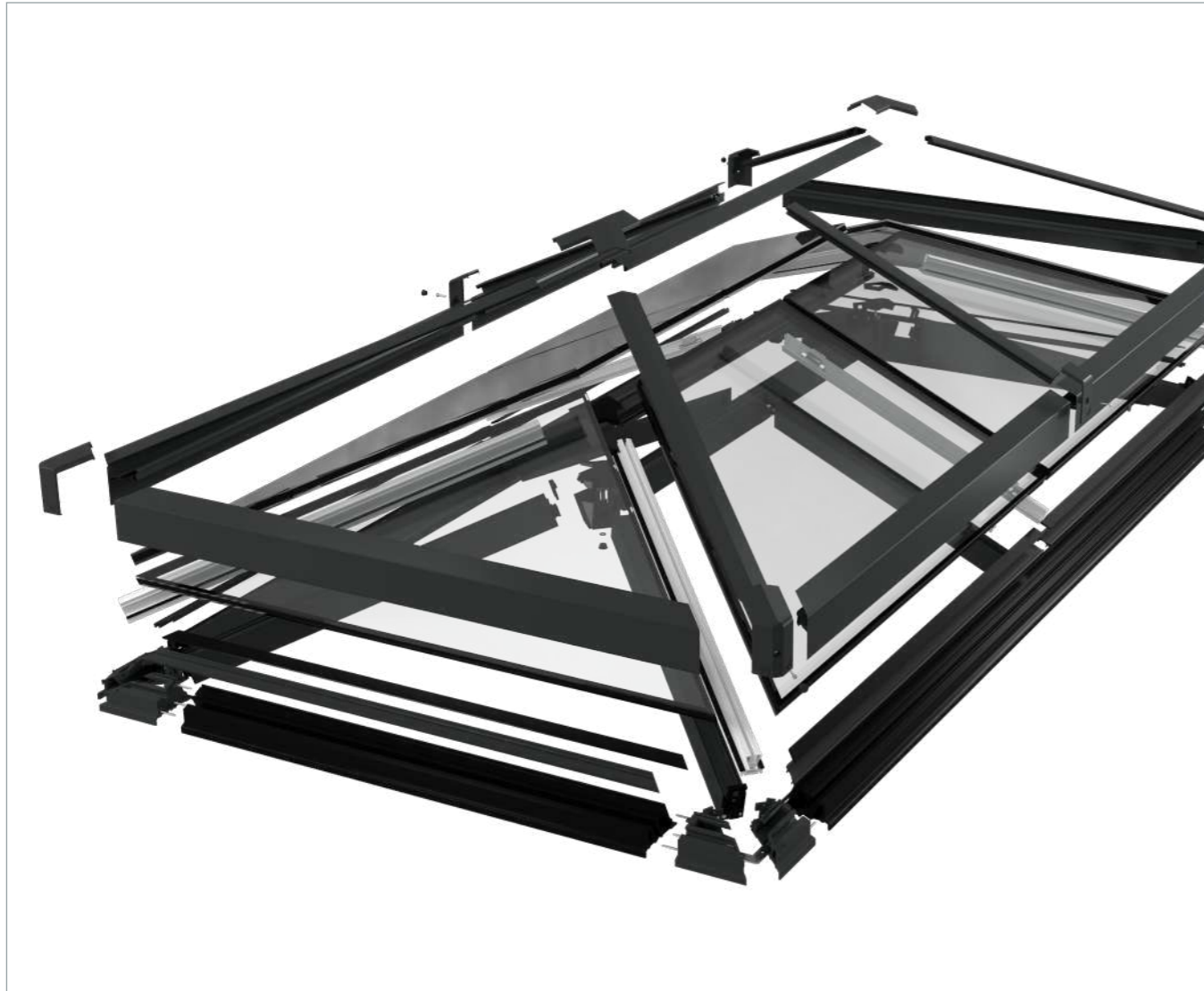

EAVES BEAM COMPONENTS – CONTINUED

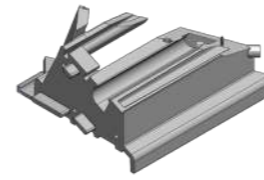

Eaves Corner LH
Material: Moulded GRP
ICQ4250LHW – White
ICQ4250LHGY1 – Grey
ICQ4250LHBK – Black

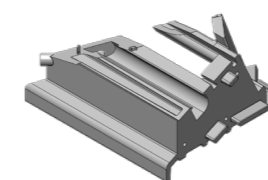

Eaves Corner RH
Material: Moulded GRP
ICQ4250RHW – White
ICQ4250RHGY1 – Grey
ICQ4250RHBK – Black

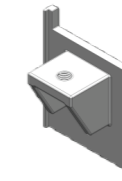

Eaves Rafter Bracket
Material: Moulded GRP
ICQ4251W – White
ICQ4251GY1 – Grey
ICQ4251BK – Black

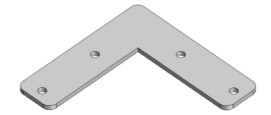

Eaves Corner Cleat
Material: Steel
ICQ4654S



Eaves Beam GRP
Screw 4.8x25
Material: Steel BZP
ICQ4650S



Eaves Frame Screw
7.5x80mm
Material: Steel BZP
ICQ4651S



Philips Pan Head
Screw 4.8x50mm
Material: Steel BZP
4.8x50PHSCREW



3.5x32mm
Material: Steel BZP
3.5x32PHSCREW

10.0 EAVES BEAM COMPONENTS

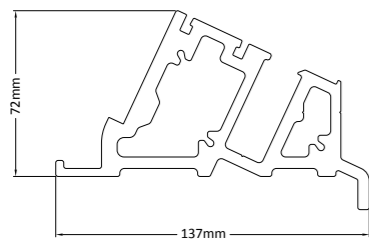

Eaves Beam
Material: Pultruded GRP
ICQ4350W – White
ICQ4350GY1M – Matt Anth Grey
ICQ4350BKM – Matt Black

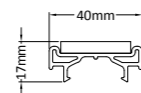

Eaves Beam Seal
Material: Extruded uPVC
ICQ4053W – White
ICQ4053GY1 – Anth Grey
ICQ4053BK – Black

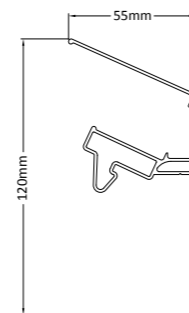

ICQ4555A
Eaves Glazing Closure
Material: Extruded Aluminium
ICQ4555AW – White
ICQ4555AGY1M – Matt Anth Grey
ICQ4555ABKM – Matt Black

10.1 HIP COMPONENTS

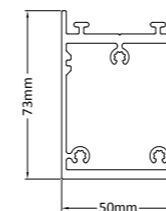

Hip Beam
Material: Extruded Aluminium
ICQ4502AW – White
ICQ4502AGY1M – Matt Anth Grey
ICQ4502ABKM – Matt Black

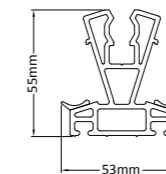

Hip Thermal Core
Material: Extruded uPVC
ICQ4012W – White

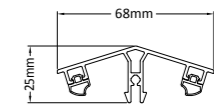

Hip Beam Top Cap
Material: Extruded Aluminium
ICQ4517AW – White
ICQ4517AGY1M – Matt Anth Grey
ICQ4517ABKM – Matt Black

HIP COMPONENTS - CONTINUED

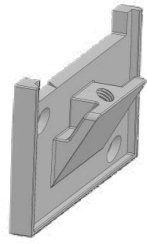

Jack Rafter Bracket LH
Material: Moulded GRP
ICQ4208LHW - White
ICQ4208LHGY1 - Anth Grey
ICQ4208LHBK - Black

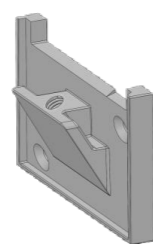

Jack Rafter Bracket RH
Material: Moulded GRP
ICQ4208RHW - White
ICQ4208RHGY1 - Anth Grey
ICQ4208RHBK - Black



Philips Self Drilling Screw
4.8 x 22mm
Material: Steel BZP
4.8x22SDCSSCREW

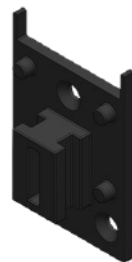

Hip Lock Plate
Material: Moulded GRP
ICQ4262BK - Black



Philips Self Tapping Screw
4.8 x 38mm
Material: Steel BZP
4.8x38CSSCREW



Q-Lok
Material: Moulded GRP
ICQ4211RED - Red



Security Screw
4.8x30mm
Material: Steel BZP
ICQ4627S

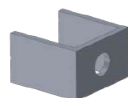

Thermal Core Security Clip
Material: Aluminium
ICQ4570A

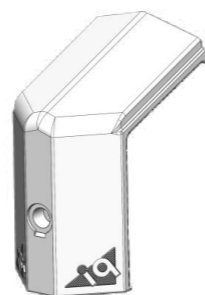

Hip End Cap
Material: Aluminium
ICQ4512AW - White
ICQ4512AGY1M - Matt Anth Grey
ICQ4512ABKM - Matt Black

HIP COMPONENTS - CONTINUED



Rafter/Hip End Cap Plug
Material: Moulded Plastic
ICQ4290W - White
ICQ4290GY1 - Grey
ICQ4290BK - Black

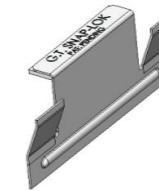

Glazing Security Clip
Material: Pressed Steel
ICQ4601S

10.2 RAFTER COMPONENTS

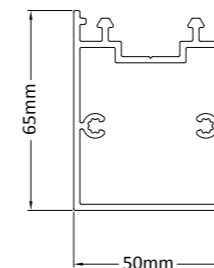

Rafter Beam
Material: Extruded Aluminium
ICQ4501AW - White
ICQ4501AGY1M - Matt Anth Grey
ICQ4501ABKM - Matt Black

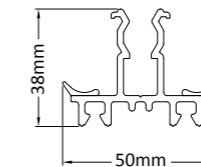

Rafter Thermal Core
Material: Extruded uPVC
ICQ4011W - White

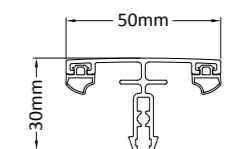

Rafter Beam Top Cap
Material: Extruded Aluminium
ICQ4516AW - White
ICQ4516AGY1M - Matt Anth Grey
ICQ4516ABKM - Matt Black

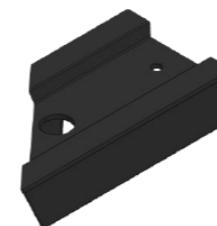

Jack Rafter Insert LH
Material: Moulded GRP
ICQ4209LHBK - Black

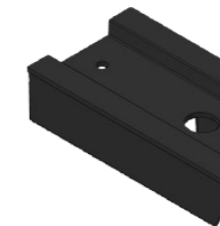

Jack Rafter Insert RH
Material: Moulded GRP
ICQ4209RHBK - Black



Eaves Beam GRP Screw
4.8x25
Material: Steel BZP
ICQ4650S
(Used with ICQ4209 & ICQ4210)

RAFTER COMPONENTS – CONTINUED



M8 Button Head Screw
Material: Steel BZP
IM8x20BHSETSCREW
(Used with ICQ4209)

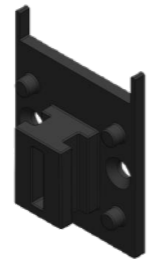

Hip Lock Plate
Material: Moulded GRP
ICQ4261BK – Black



Philips Self Tapping Screw
4.8 x 38mm
Material: Steel BZP
4.8x38CSSCREW



Q-Lok
Material: Moulded GRP
ICQ4211RED – Red

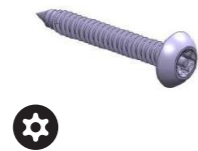

Security Screw
4.8x30mm
Material: Steel BZP
ICQ4627S

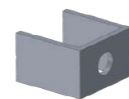

Thermal Core Security Clip
Material: Aluminium
ICQ4570A



Rafter End Cap
Material: Aluminium
ICQ4511AW – White
ICQ4511AGY1M – Matt Anth Grey
ICQ4511ABKM – Matt Black



Rafter/Hip End Cap Plug
Material: Moulded Plastic
ICQ4290W – White
ICQ4290GY1 – Grey
ICQ4290BK – Black

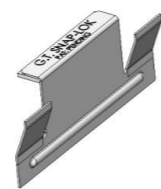

Glazing Security Clip
Material: Pressed Steel
ICQ4601S

10.3 RIDGE COMPONENTS

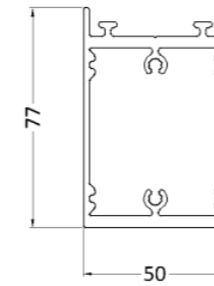

Ridge Beam Top Cap
Material: Extruded Aluminium
ICQ4521AW – White
ICQ4521AGY1M – Matt Anth Grey
ICQ4521ABKM – Matt Black

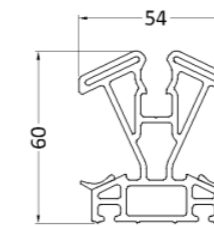

Ridge Thermal Core
Material: Extruded uPVC
ICQ4021W – White

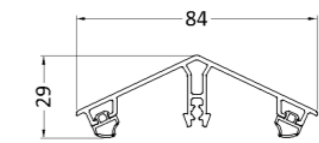

Ridge Beam Top Cap
Material: Extruded Aluminium
ICQ4521AW – White
ICQ4521AGY1M – Matt Anth Grey
ICQ4521ABKM – Matt Black



Ridge Lock Plate
Material: Moulded GRP
ICQ4260BK – Black



Philips Self Tapping Screw
4.8 x 38mm
Material: Steel BZP
4.8x38CSSCREW

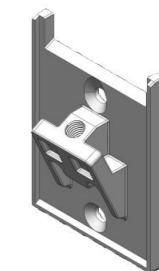

Ridge Rafter Bracket
Material: Moulded GRP
ICQ4263W – White
ICQ4263GY1 – Grey
ICQ4263BKM – Matt Black



Philips Self Drilling Screw
4.8 x 22mm
Material: Steel BZP
4.8x22SDCSSCREW



Security Screw
4.8x30mm
Material: Steel BZP
ICQ4627S

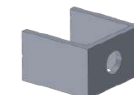

Thermal Core Security Clip
Material: Aluminium
ICQ4570A

10.4 2-WAY RIDGE END COMPONENTS

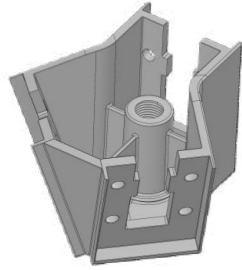

2-Way Spider
Material: Moulded GRP
ICQ4222W – White
ICQ4222GY1 – Grey
ICQ4222BK – Black

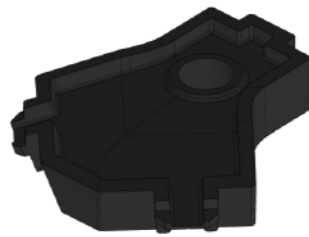

2-Way Spider Insert
Material: Moulded GRP
ICQ4232BK – Black
(Part of Kit ICQ4932BK)

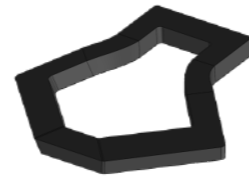

2-Way Btm Spider Gasket
Material: Closed Cell Foam
ICQ4432BK – Black
(Part of Kit ICQ4932BK)



2-Way Top Spider Gasket
Material: Closed Cell Foam
ICQ4442BK – Black
(Part of Kit ICQ4932BK)



Q-Lok
Material: Moulded GRP
ICQ4211RED – Red



Spider Bolt Kit
Material: Moulded Nylon
ICQ4980
(ICQ4280 Insert Retaining Screw)
(ICQ4281 M8x110 Cap HD Screw)
(ICQ4282 M8 Washer)

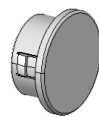

Spider Plug
Material: Moulded Plastic
ICQ4291W – White
ICQ4291GY1 – Grey
ICQ4291BK – Black

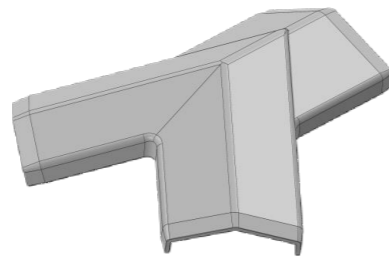

3-Way Spider Top Cap
Material: Aluminium
ICQ4523AW – White
ICQ4523AGY1M – Matt Anth Grey
ICQ4523ABKM – Matt Black

10.5 3-WAY RIDGE END COMPONENTS

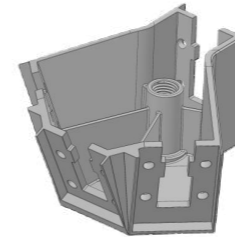

3-Way Spider
Material: Moulded GRP
ICQ4223W – White
ICQ4223GY1 – Grey
ICQ4223BK – Black

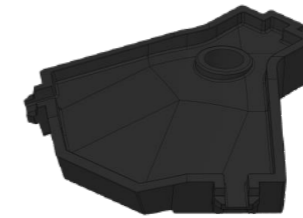

3-Way Spider Insert
Material: Moulded GRP
ICQ4233BK – Black
(Part of Kit ICQ4933BK)



3-Way Btm Spider Gasket
Material: Closed Cell Foam
ICQ4433BK – Black
(Part of Kit ICQ4933BK)

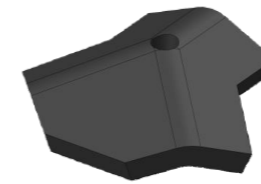

3-Way Top Spider Gasket
Material: Closed Cell Foam
ICQ4443BK – Black
(Part of Kit ICQ4933BK)



Q-Lok
Material: Moulded GRP
ICQ4211RED – Red



Spider Bolt Kit
Material: Moulded Nylon
ICQ4980
(ICQ4280 Insert Retaining Screw)
(ICQ4281 M8x110 Cap HD Screw)
(ICQ4282 M8 Washer)

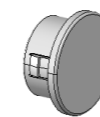

Spider Plug
Material: Moulded Plastic
ICQ4291W – White
ICQ4291GY1 – Grey
ICQ4291BK – Black

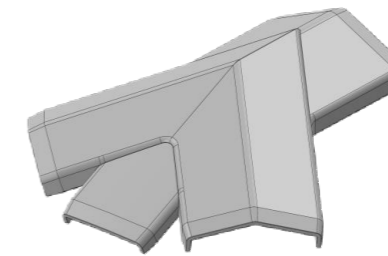

3-Way Spider Top Cap
Material: Aluminium
ICQ4523AW – White
ICQ4523AGY1M – Anth Grey
ICQ4523ABKM – Matt Black

10.6 4-WAY RIDGE END COMPONENTS

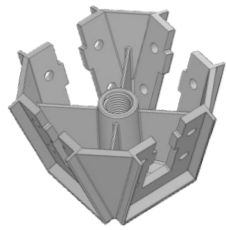

4-Way Spider
Material: Moulded GRP
ICQ4224W – White
ICQ4224GY1 – Grey
ICQ4224BK – Black

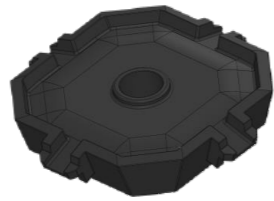

4-Way Spider Insert
Material: Moulded GRP
ICQ4234BK – Black
(Part of Kit ICQ4934BK)

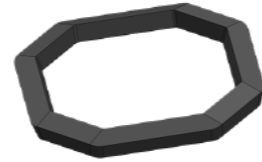

4-Way Btm Spider Gasket
Material: Closed Cell Foam
ICQ4434BK – Black
(Part of Kit ICQ4934BK)

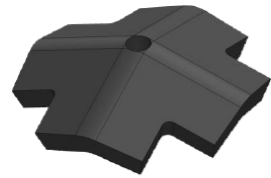

4-Way Top Spider Gasket
Material: Closed Cell Foam
ICQ4444BK – Black
(Part of Kit ICQ4934BK)



Q-Lok
Material: Moulded GRP
ICQ4211RED – Red



Spider Bolt Kit
Material: Moulded Nylon
ICQ4980
(ICQ4280 Insert Retaining Screw)
(ICQ4281 M8x110 Cap HD Screw)
(ICQ4282 M8 Washer)



Spider Plug
Material: Moulded Plastic
ICQ4291W – White
ICQ4291GY1 – Grey
ICQ4291BK – Black

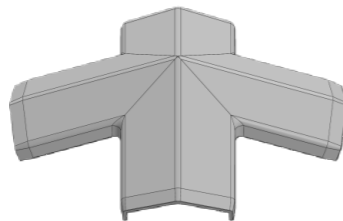

4-Way Spider Top Cap
Material: Aluminium
ICQ4524AW – White
ICQ4524AGY1M – Matt Anth Grey
ICQ4524ABKM – Matt Black

11. CROSS SECTIONS

11.0 EAVES

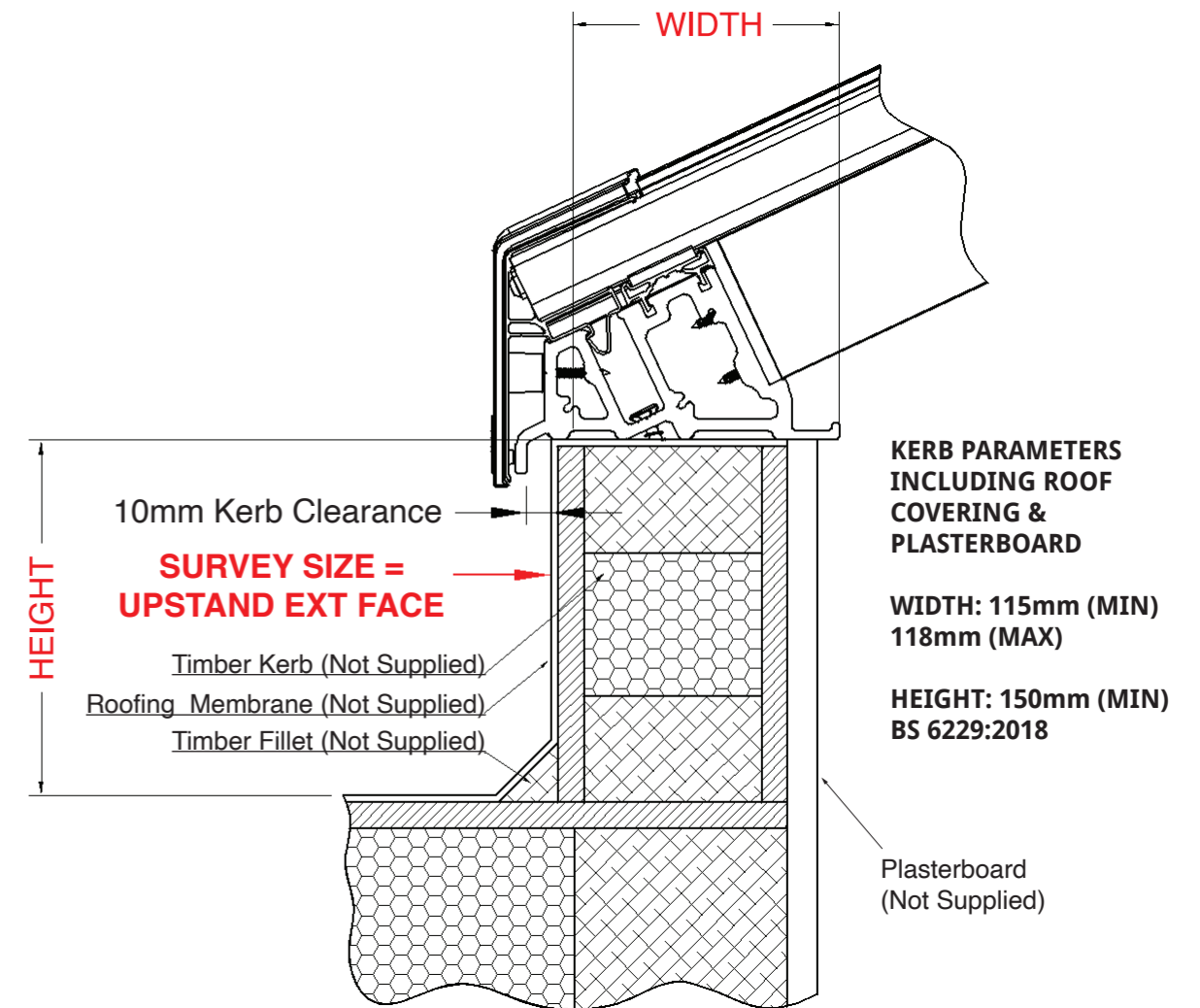

ICQ4350
ICQ4053
ICQ4555A

GRP Eaves Beam
Eaves Beam Seal
Eaves Glazing Closure

11. CROSS SECTIONS

11.1 RIDGE

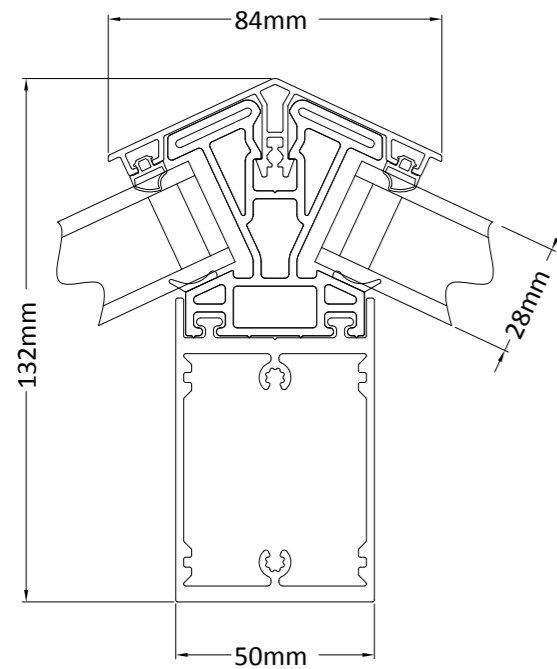

ICQ4521A Ridge Beam Top Cap
 ICQ4021W Ridge Thermal Core
 ICQ4520A Ridge Beam

11.2 HIP

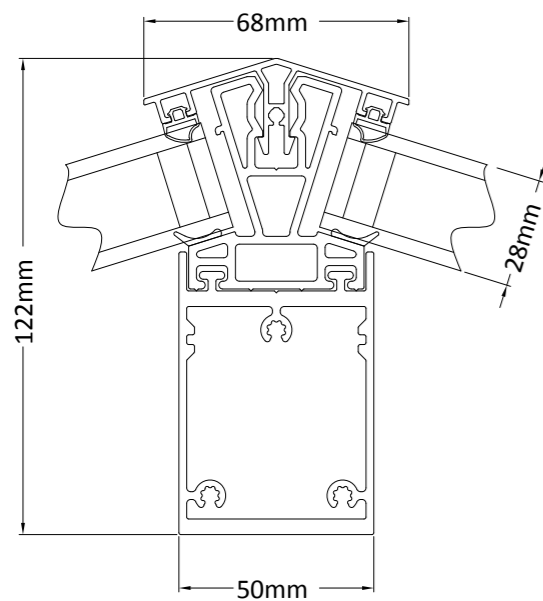

ICQ4517A Hip Beam Top Cap
 ICQ4012W Hip Thermal Core
 ICQ4502A Hip Beam

11.3 RAFTER

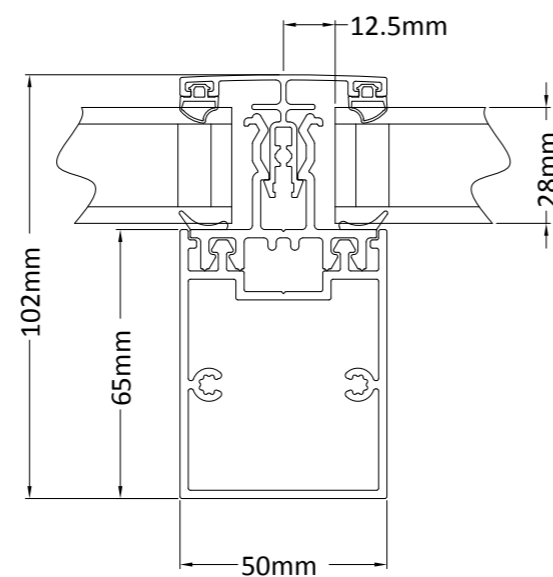

ICQ4516A Rafter Beam Top Cap
 ICQ4011W Rafter Thermal Core
 ICQ4501A Rafter Beam

12. CARE & MAINTENANCE

12.0



What can I use to clean the framework and glass?

- Warm water with soap (e.g. washing up liquid) can be used, do not use non-approved abrasive or solvent cleaners. Please visit the glass manufacturers website for more information on approved cleaners.

- Do not use high pressure jet washers

Do not contaminate the self-cleaning glass with Silicone.

- Do not use any non-approved sealants on or near the self-cleaning glass. Iconiq Roof Lanterns are designed to eliminate the requirement for additional sealants.
- Ensure hands are washed thoroughly after working with any silicone sealants or silicone coated products.
- If contamination occurs refer to glass manufacturers website on latest guidelines to remove contamination.

Full product range



Deeplas Roofline



Coastline Lightweight Composite Cladding



Equinox Tiled Roof System



Skypod Lantern Roofs



Twinson Premium Cladding



Internal Wall and Ceiling Panels

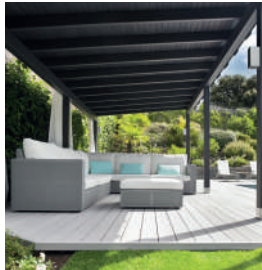

Twinson Decking



Roomline PVC-U Skirting



Deeplas Embossed Cladding



Slateskin GRP Sheet Tile System



Deeplas Window Boards



Rainwater

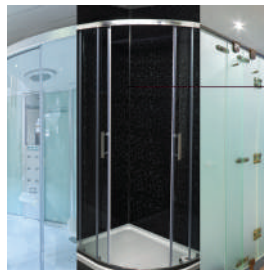

Shower Panels



Garden Rooms



Iconiq Roof Lanterns



Customer service

If you need any assistance, please call the Customer Services team on the following number or visit deeplas.co.uk



01773 842 336