



Creative Paradise Inc.



Make your own Lily

Make a bunch of stunning lillies in glass - flowers that will never die!

The following instructions enable you to make a lily using the Lily Mould (CPLF223) and the Cone Former Mould (CPGM50).

You will need to following to create this project:

- Creative Paradise, Inc. moulds CPLF223 & CPGM50
- Powder sifter
- ZYP
- COE96 Frits in F1 Powder & F2 Fine
- Kiln paper



Ensure your mould is well primed before use

By using a primer this will prevent the glass sticking to the mould and potentially damaging the mould and the glass, make sure you use a small brush for detailed areas and dry thoroughly.

Creative Paradise highly recommend using ZYP a Boron Nitride spray due to the high temperatures required, this easy to apply spray can fire up to 982°C. Several light coats with a short waiting period of around 15 minutes between coats is preferable to one heavy coat. Shake the can well before use and hold the can upright while using to assure proper distribution of product. You will need to apply one light coat each time you fire.

The process

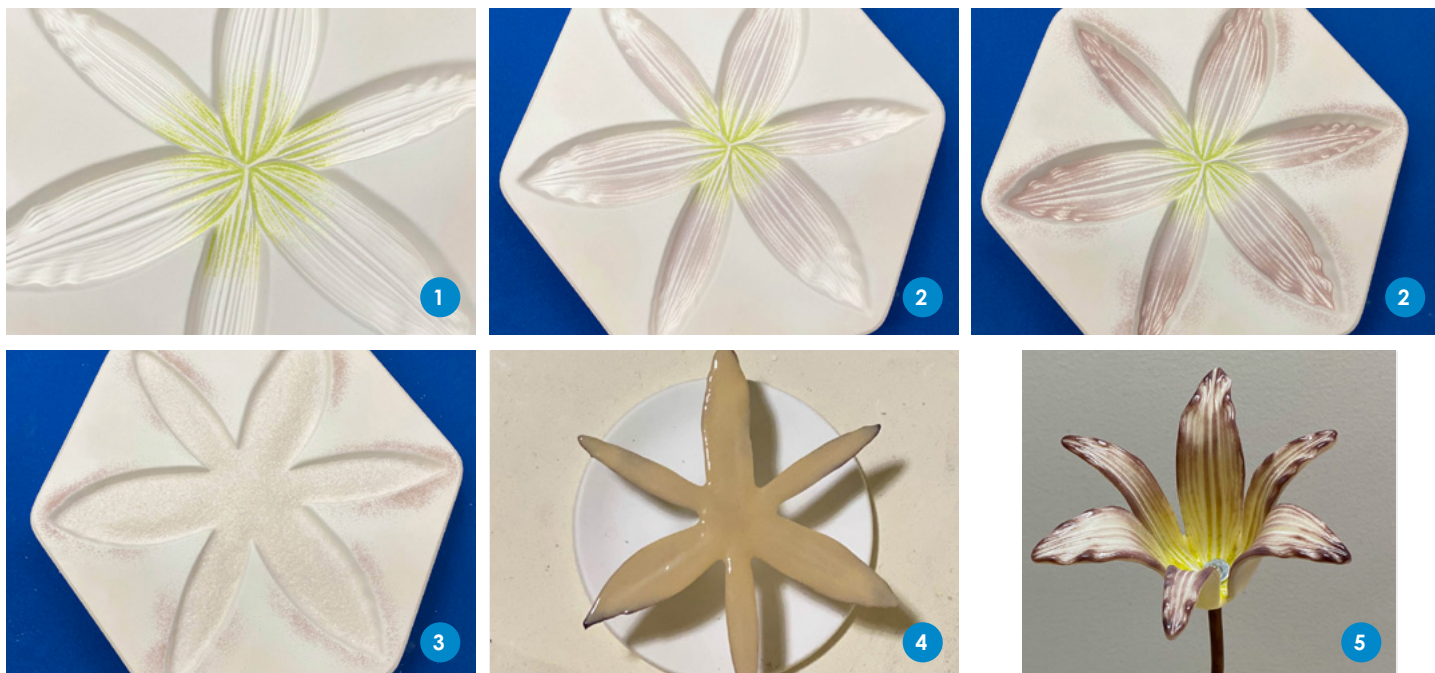

1 Create the detail in the centre of the flower

Sift F1 Moss Green into the center of the cavity placing the Moss Green frit up each petal about 1 inch.

2 Create the detail of the petals

Sift F1 Mauve into the cavity from the edge of the Moss up each petal stopping at 1" from the tip of each petal.

Sift F1 Plum into the tip of each petal and along the edge of the top of the petals.

3 Fill the rest of the mould

Place F2 Champagne Opal over the entire cavity until the mold is holding 100 grams of frit (or approximately 3/8" of frit). Fire the project to a tack fire. A suggested schedule can be found in the table overleaf.

3 Slump the lily to create the shape

After the project is cooled, place the glass Lily on to a GM50 with the textured/colourful side down and with the flower centered on the mould. Slump the project using the suggested schedule found in the table overleaf.

We have a wide variety of slumping moulds that you can slump the Lily on such as the GM195, however you will need to place the Lily texture side up on this particular mould when slumping.



The process

Lily casting mould firing schedule - tack fuse

Segment	Rate Celsius/hr	Temp	Hold time (hr:min)
1.	166°C/hr	to 621°C	0:30
2.	194°C/hr	to 771°C	0:10
3.	AFAP* OR 9999°C/hr	to 510°C	1:00

Lily casting mould firing schedule - slump

Segment	Rate Celsius/hr	Temp	Hold time (hr:min)
1.	138°C/hr	to 676°C**	0:10
2.	AFAP* OR 9999°C/hr	to 510°C	1:00

*AFAP = as fast as possible, some controllers will not allow a rate of 9999°C /hr

** You may also want to increase the top temp to 704°C if you want a deeper slump for your Lily on the GM195. (But do not increase this temp if you are slumping on the GM50).