



*Creative Paradise Inc.*



# Using the gecko frit casting mould

Make yourself a beautiful gecko using the frit casting mould, perfect for indoors or your garden.

The following instructions enable you to make a beautiful tree frog using the Tree Frog Casting Mould (CPLF207).

## You will need to following to create this project:

- Creative Paradise, Inc. mould CPLF207
- Powder sifter
- Pipette
- ZYP
- COE96 Frits: F1 Black, F3 Black, Clear, Pale Amber, Vanilla Cream
- Tweezers



## Ensure your mould is well primed before use

By using a primer this will prevent the glass sticking to the mould and potentially damaging the mould and the glass, make sure you use a small brush for detailed areas and dry thoroughly.

Creative Paradise highly recommend using ZYP a Boron Nitride spray due to the high temperatures required, this easy to apply spray can fire up to 982°C. Several light coats with a short waiting period of around 15 minutes between coats is preferable to one heavy coat. Shake the can well before use and hold the can upright while using to assure proper distribution of product. You will need to apply one light coat each time you fire.

# The process

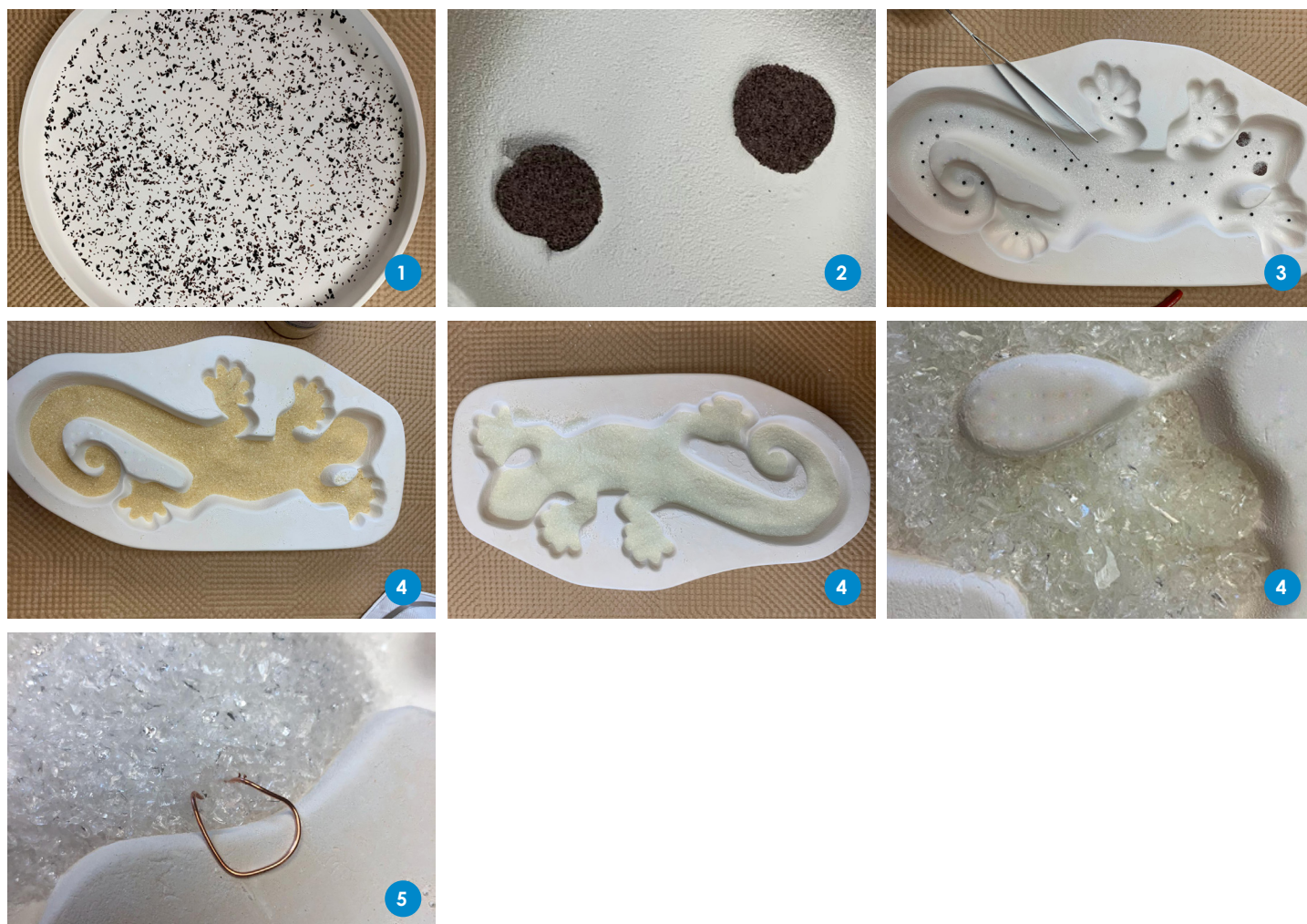

## 1 Make some black dots

You can do this by sprinkling F3 Black Frit onto a ZYP treated kiln shelf. We like to use our Patty Gray round dam moulds (the edge of these moulds stop the balls from rolling off the surface). Fire using your favourite full fuse schedule.

## 2 Create the eyes

Use a powder vibe to place F1 Black into the eyes of the Gecko.

## 3 Place the black dots

Sprinkle some F2 Clear frit in the mould where you plan to place the black dots. Use a tweezers to pick up the dots and place them in various areas on the clear frit. Putting clear frit down first, stops the balls from rolling around in the mould.

## 4 Create the body

Sprinkle F2 Pale Amber in the body of the Gecko.

Sprinkle F2 Almond Opal over the Pale Amber in the body of the Gecko.

Tip: Sweep the glass so that it does not go over the wall between the face and the hand otherwise the glass may fuse together between the hand and face.

## 5

## Frit Reactions

Fill the mould with F2 Clear frit until the frit in the mould weighs 296 grams. Place pieces of 18 guage copper wire bent into U shapes into the clear frit, where you would like the Gecko to hang. Make sure the curved side is out of the frit and leans against the mould wall (see image above). Fire the mould to a full fuse that works best in your kiln, or use our suggested schedule found in the table below.

### Gecko mould firing schedule - full fuse

Segment	Rate Celsius/hr	Temp	Hold time (hr:min)
1.	166°C/hr	to 621°C	0:45
2.	83°C/hr	to 743°C	0:20
3.	222°C/hr	to 790°C**	0:10
4.	AFAP* OR 9999°C/hr	to 510°C	1:00
5.	55°C/hr	to 426°C	0:05

\*AFAP = as fast as possible, some controllers will not allow a rate of 9999°C /hr

\*\* Will vary depending on desired result and kiln

#### Note:

This data is a guide only, firing programs may need to be adjusted according to size and thickness of glass and the kiln's performance. Ensure that data is entered into the controller accurately, otherwise glass may not fuse correctly or paint will not fire onto the glass as desired. Creative Glass Guild sells all glass, tools and materials on the basis that customers have the knowledge and ability to use them safely and in accordance with all relevant regulations and legislation.